

**Uflow**™  
Solenoid Valve  
INDIA

Specialized in fluid automation...



Solenoid Valve

Pneumatically Control Valve

Gas Solenoid Valve

High Pressure Valve

Actuators

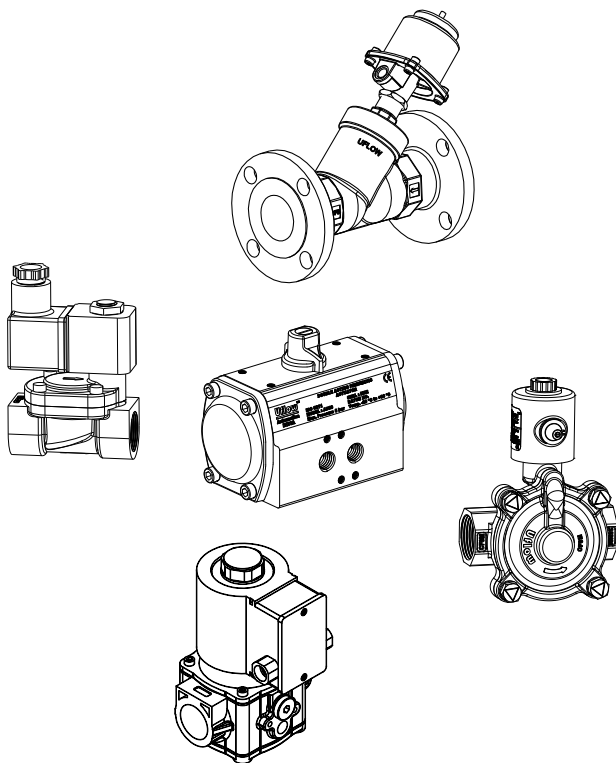

## Company Profile



**Uflow Automation** is an engineering organization committed to provide complete solutions to customers' requirements. We are established in year 2007 and progressing with a vision of applying finest engineering practices in Valve manufacturing industry by our restless and high skilled ENGINEERS, standard organizational PROCESSES and superior quality PRODUCTS.

We are leading in Solenoid Valve manufacturing company in India, known as **Uflow™** Our range of products includes – Pilot Operated Diaphragm Type Valves, Pneumatically Control Valves, Gas Solenoid Valves and High Pressure Valves. Our products are being sold across INDIA and being exported outside India in various other countries.

### Our Quality

In-house full scale Testing Facility  
Lean Manufacturing practices / Six Sigma, Kaizen, 5S  
Certified by: ISO 9001:2008 (TUV SUD), CE, ERDA, CIMFR, BIS, PESO

### Our Commitment

To understand customers' NEEDS first before proposing our product  
To keep providing competitive RATES by continuously improvement in process without compromising in quality  
To provide continuous support to our customers and go beyond their expectations in terms of delivery and after sale services

### About Us

In house R&D, Manufacturing and Testing facility in single location at Gujarat, India  
Authorized distributor channels in 20 different states in India  
Sales office in Qatar, Vietnam and Australia (Expanding)

We started building our products for a specific market segment and then over the period of time we progressed to built it for various sectors that includes:

Textile	Water Treatment	Energy & Power	Packaging
Pharmaceutical	Oil & Gas	Nuclear	Marine
Chemical	Food and beverage	Steel & Cement	Automotive

We Stand amongst the pioneers of the industry because of our following competitive advantages :

- **Total Quality Management** Allow us to maintain quality of our products.
- We follow genuine customer relationship policy and that help us to build **trusted relationships**.
- We believe in **timely delivery** with and consistent quality standards, **State of art testing facility** to ensure our customers don't have complains.
- **Innovative** products range with sophisticated and **latest technology**. Excellent **R&D** team allow us to develop new product faster.
- Highly accessible **customer services** team facilities to interact with our customers. Feel free to ask us for our Customer references and product samples.

**Uflow** quality is based on the platform of process control granting the elimination of variances, a computerized integrated system able to guarantee the quality of products, the recording each production step to ensure effective data analysis as well as a complete and efficient traceability of both components and finished products, always maintaining standards of high competitiveness in the marketplace.

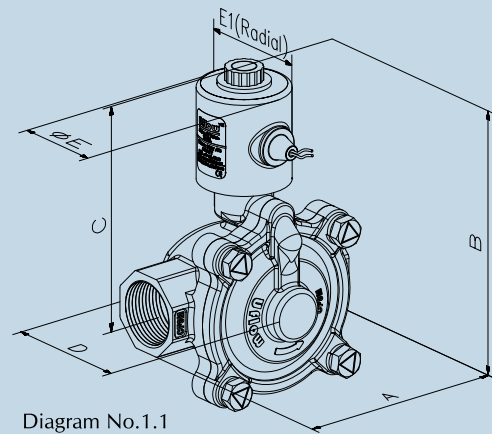
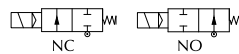

Diagram No.1.1



## Specifications :

Port :	Refer below technical data sheet(Available BSP / NPT)				
End Connection :	Screwed / Flange				
Body Material :	SS ASTM A351 Grade CF8 / CF8M				
Diaphragm :	Nitrile (NBR)	EPDM	Viton (FKM)		
Media Temp :	-30° C to 90° C	-10° C to 140° C	-10° C to 180° C		
Circumstance Temp :	-10° C to 90° C				
Media :	Air, Water, Chemical, Gases, Oil, Diesel, Kerosene, LPG.				
Main Features :	Internal Parts are in superior corrosion resistance steel (Equivalent to SS316L) Suitable for Food Industries, Pharmaceuticals, Chemical applications & Highly corrosive environment.				
Operating Voltage :	24 AC	110 AC	230 AC	12 DC	24 DC
Power Consumption :	7W	8W	9W / 17W	10W	11W
Coil Features :	High Reliability Unaffected by Voltage Surges. Easy coil changes coil lockable in 4X90 position or freely movable in between as require.				
Coil Housing :	Epoxy square coil, metallic round enclosure, IP-67 Flame proof enclosure, IP-68 Weather proof enclosure.				
Optional Feature :	90% Power saver series also available, Manual Override, Water hammering reducer also available to avoid water hammer forces				
Other Specification Data :	Available on Request				

## Dimension : (NC)

All dimensions are in mm

Model No.	Port Size	Diagram No.	A	B	C	D	E	E1
PCN28	1/2"	1.1	73	127	99	50	44	58
PCN38	3/4"	1.1	81	144	103	59	44	58
PCN48	1"	1.1	104	152	112	67	44	58
PCN58	1 1/4"	1.1	108	172	116	90	44	58
PCN68	1 1/2"	1.1	108	172	116	90	44	58
PCN88	2"	1.1	132	192	126	100	44	58
PCN96	2 1/2"	1.1	166	211	140	127	44	58
PCNA6	3"	1.1	192	237	152	142	44	58



Section View

**NOTE :** USE OF FILTER IN THE INLET PORT IS RECOMMENDED.

## Technical Data :

Model No.	Body Material	Pipe (inch)	Orifice (mm)	Min. Operating Pressure kg/cm <sup>2</sup>	Max. Operating Pressure kg/cm <sup>2</sup>	Seal & Diaphragm Material	Flow Factor Kv m <sup>3</sup> /hr
PCN28	CF8 / CF8M	1/2"	17.00	0.5	12	NBR / EPDM / VITON	3.2
PCN38	CF8 / CF8M	3/4"	20.00	0.5	12	NBR / EPDM / VITON	5.0
PCN48	CF8 / CF8M	1"	25.00	0.5	12	NBR / EPDM / VITON	8.2
PCN58	CF8 / CF8M	1 1/4"	34.00	0.5	12	NBR / EPDM / VITON	12.2
PCN68	CF8 / CF8M	1 1/2"	36.00	0.5	12	NBR / EPDM / VITON	17.1
PCN88	CF8 / CF8M	2"	47.00	0.5	12	NBR / EPDM / VITON	29.9
PCN96	CF8 / CF8M	2 1/2"	60.00	0.30	10	NBR / EPDM / VITON	43.5
PCNA6	CF8 / CF8M	3"	72.00	0.30	10	NBR / EPDM / VITON	64.5

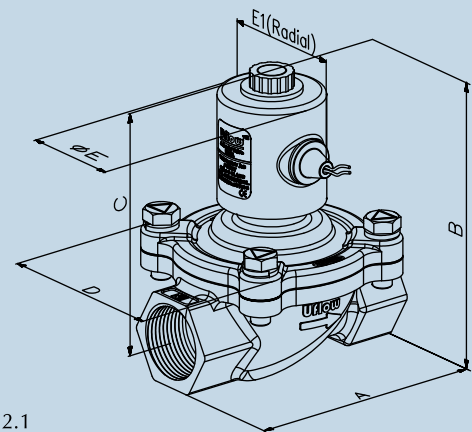
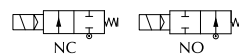

Diagram No.2.1



## Specifications :

## Dimension : (NC)

Port :	Refer below technical data sheet(Available BSP / NPT)				
End Connection :	Screwed / Flange				
Body Material :	SS ASTM A351 Grade CF8 / CF8M, Forged Brass				
Diaphragm :	Nitrile (NBR)	EPDM	Viton (FKM)	PTFE	
Media Temp :	-30° C to 90° C	-10° C to 140° C	-10° C to 180° C	-10° C to 180° C	
Circumstance Temp :	-10° C to 90° C				
Media :	Air, Water, Chemical, Gases, Oil, Steam, LPG.				
Main Features :	Internal Parts are in superior corrosion resistance steel (Equivalent to SS316L) Suitable for Food Industries, Pharmaceuticals, Chemical Application & Highly corrosive environment. suitable for horizontal position.				
Operating Voltage :	24 AC	110 AC	230 AC	12 DC	24 DC
Power Consumption :	7W	8W	9W / 17W	10W	11W
Coil Features :	High Reliability Unaffected by Voltage Surges. Easy coil changes coil lockable in 4X90 position or freely movable in between as require.				
Coil Housing :	Epoxy square coil, metallic round enclosure, IP-67 Flame proof enclosure, IP-68 Weather proof enclosure.				
Optional Feature :	90% Power saver series also available, Water hammering reducer also available to avoid water hammer forces • Special High Flow Rate series available on request at low pressure or Gravity pressure application				
Other Specification Data :	Available on Request				

All dimensions are in mm

Model No.	Port Size	Diagram No.	A	B	C	D	E	E1
MBN73	3/8"	2.1	65	108	93	50	44	58
MBN23	1/2"	2.1	65	108	93	50	44	58
MCN23	1/2"	2.1	69	108	95	56	44	58
MCN33	3/4"	2.1	82	117	99.25	63	44	58
MCN43	1"	2.1	104.5	124	105	82	44	58
MCN6D3	1 1/2"	2.1	108	151	124	89	50	63
MCN8D3	2"	2.1	137	171	137	120	50	63

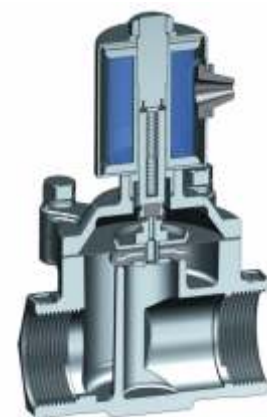

Section View

**NOTE :** USE OF FILTER IN THE INLET PORT IS RECOMMENDED.  
PREFERABLY OVER HORIZONTAL PIPELINE WITH THE COIL UPRIGHT.

**Caution :** AC coil should not be used on a DC coil valve and vice versa.

## Technical Data :

Model No.	Body Material	Pipe (inch)	Orifice (mm)	Min. Operating Pressure kg/cm <sup>2</sup>	Max. Operating Pressure kg/cm <sup>2</sup>	Seal & Diaphragm Material	Flow Factor Kv m <sup>3</sup> /hr
MBN73	Brass	3/8"	15.50	0	7	NBR / EPDM / VITON	2.5
MBN23	Brass	1/2"	15.50	0	7	NBR / EPDM / VITON	3.1
MCN23	CF8/ CF8M	1/2"	17.00	0	7	NBR / EPDM / VITON / PTFE	3.2
MCN33	CF8/ CF8M	3/4"	20.00	0	7	NBR / EPDM / VITON / PTFE	5.0
MCN43	CF8/ CF8M	1"	25.50	0	7	NBR / EPDM / VITON / PTFE	8.2
MCN6D3	CF8/ CF8M	1 1/2"	35.00	0	4	NBR / EPDM / VITON	18.20
MCN8D3	CF8/ CF8M	2"	48.00	0	4	NBR / EPDM / VITON	31.40



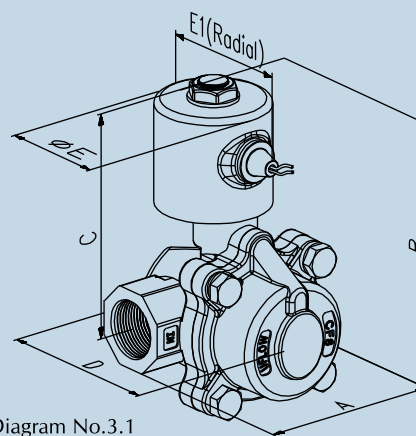
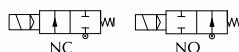

Diagram No.3.1



## Specifications :

Port :	Refer below technical data sheet(Available BSP / NPT)					
End Connection :	Screwed / Flange					
Body Material :	SS ASTM A351 Grade CF8 / CF8M					
Seal & 'O' Ring :	PTFE + Silicon / Viton					
Circumstance Temp :	-10° C to 180° C					
Media Temp :	-10° C to 180° C					
Media :	Steam, Hot Water, Hot Fluid, Water, Oil					
Main Features :	Internal Parts are in superior corrosion resistance steel (Equivalent to SS316L) Suitable for Food Industries, Pharmaceuticals, Chemical applications & Highly corrosive environment.					
Operating Voltage :	<table border="1"> <tr> <td>24 AC</td> <td>110 AC</td> <td>230 AC</td> <td>12 DC</td> <td>24 DC</td> </tr> </table>	24 AC	110 AC	230 AC	12 DC	24 DC
24 AC	110 AC	230 AC	12 DC	24 DC		
Power Consumption :	<table border="1"> <tr> <td>7W</td> <td>8W</td> <td>9W / 17W</td> <td>10W</td> <td>11W</td> </tr> </table>	7W	8W	9W / 17W	10W	11W
7W	8W	9W / 17W	10W	11W		
Coil Features :	High Reliability Unaffected by Voltage Surges. Easy coil changes coil lockable in 4X90 position or freely movable in between as require.					
Coil Housing :	Epoxy square coil, metallic round enclosure, IP-67 Flame proof enclosure, IP-68 Weather proof enclosure.					
Optional Feature :	90% Power saver series also available, Manual Override, Water hammering reducer also available to avoid water hammer forces					
Other Specification Data :	Available on Request					

## Dimension : (NC)

All dimensions are in mm

Model No.	Port Size	Diagram No.	A	B	C	D	E	E1
HCP29	1/2"	3.1	73	127	98	63	44	58
HCP39	3/4"	3.1	81	136	103	73	44	58
HCP49	1"	3.1	104	152	112	80	44	58
HCP69	1 1/2"	3.1	118	167	117	113	44	58
HCP89	2"	3.1	132	192	126	116	44	58

In Normally open valve Dimension will increase up to 8mm in B & C



Section View

NOTE : USE OF FILTER IN THE INLET PORT IS RECOMMENDED.

## Technical Data :

Model No.	Body Material	Pipe (inch)	Orifice (mm)	Min. Operating Pressure kg/cm <sup>2</sup>	Max. Operating Pressure kg/cm <sup>2</sup>	Seal & 'O' Ring Material	Flow Factor Kv m <sup>3</sup> /hr
HCP29	CF8 / CF8M	1/2"	17.00	1.5	12	PTFE	2.3
HCP39	CF8 / CF8M	3/4"	20.00	1.5	12	PTFE	4.0
HCP49	CF8 / CF8M	1"	25.00	1.5	12	PTFE	6.0
HCP69	CF8 / CF8M	1 1/2"	34.00	1.5	12	PTFE	13.0
HCP89	CF8 / CF8M	2"	47.00	1.5	12	PTFE	13.6
HCP2A	CF8 / CF8M	1/2"	17.00	1.5	40	PTFE	2.0
HCP3A	CF8 / CF8M	3/4"	20.00	1.5	40	PTFE	3.5
HCP4A	CF8 / CF8M	1"	25.00	1.5	40	PTFE	5.2
HCP6A	CF8 / CF8M	1 1/2"	34.00	1.5	40	PTFE	11.5

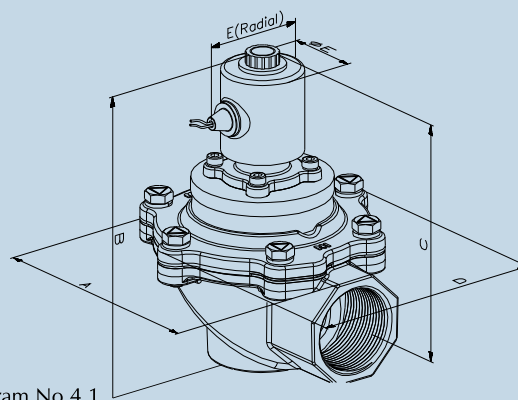
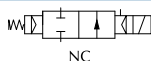

Diagram No.4.1



## Specifications :

Port :	Refer below technical data sheet(Available BSP)				
End Connection :	Screwed				
Body Material :	Aluminum Die Cast				
Diaphragm :	Nitrile (NBR)				
Circumstance Temp :	-10° C to 90° C				
Media Temp :	-10° C to 90° C				
Media :	Air				
Main Features :	Internal Parts are in superior corrosion resistance steel (Equivalent to SS316L) Suitable for Air Pollution Control System, Bag Filter Machine				
Operating Voltage :	24 AC	110 AC	230 AC	12 DC	24 DC
Power Consumption :	7W	8W	9W / 17W	10W	11W
Coil Features :	High Reliability Unaffected by Voltage Surges. Easy coil changes coil lockable in 4X90 position or freely movable in between as require.				
Coil Housing :	Epoxy square coil, metallic round enclosure, IP-67 Flame proof enclosure, IP-68 Weather proof enclosure.				
Optional Feature :	90% Power saver series also available.				
Other Specification Data :	Available on Request				

## Dimension :

All dimensions are in mm

Model No.	Port Size	Diagram No.	A	B	C	D	E	E1
JAN47	1"	4.1	90	133	109.75	75	44	58
JAN67	1 1/2"	4.1	137	170	134	136	44	58



Section View

NOTE : USE OF FILTER IN THE INLET PORT IS RECOMMENDED.

## Technical Data :

Model No.	Body Material	Pipe (inch)	Orifice (mm)	Min. Operating Pressure kg/cm <sup>2</sup>	Max. Operating Pressure kg/cm <sup>2</sup>	Seal & Diaphragm Material	Flow Factor Kv m <sup>3</sup> /hr
JAN47	Aluminium	1"	29.00	0.5	8.5	NBR	16
JAN67	Aluminium	1 1/2"	52.00	0.5	8.5	NBR	40

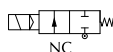
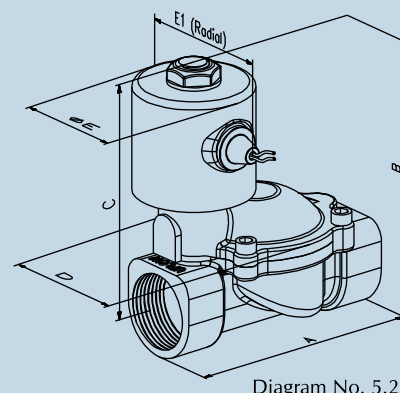
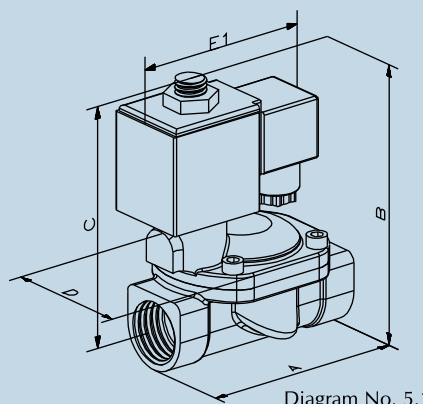

## Specifications :

## Dimension :

Port :	Refer below technical data sheet(Available BSP / NPT)				
End Connection :	Screwed / Flange				
Body Material :	SS ASTM A351 Grade CF8 / CF8M, Forged Brass				
Diaphragm :	Nitrile (NBR)	EPDM	Viton (FKM)		
Media Temp :	-30° C to 90° C	-10° C to 140° C	-10° C to 180° C		
Circumstance Temp :	-10° C to 90° C				
Media :	Air, Water, Chemical, Gases, Oil, Diesel, Kerosene, LPG.				
Main Features :	Internal Parts are in superior corrosion resistance steel (Equivalent to SS316L) Suitable for Food Industries, Pharmaceuticals, Chemical applications & Highly corrosive environment.				
Operating Voltage :	24 AC	110 AC	230 AC	12 DC	24 DC
Power Consumption :	7W	8W	9W / 17W	10W	11W
Coil Features :	High Reliability Unaffected by Voltage Surges. Easy coil changes coil lockable in 4X90 position or freely movable in between as require.				
Coil Housing :	Epoxy square coil, metallic round enclosure, IP-67 Flame proof enclosure, IP-68 Weather proof enclosure.				
Optional Feature :	90% Power saver series also available, Water hammering reducer also available to avoid water hammer forces				
Other Specification Data :	Available on Request				

All dimensions are in mm

Model No.	Port Size	Diagram No.	A	B	C	D	E	E1
PBN260	1/2"	5.2	60.50	95	65	38	26	61
PBN36	3/4"	5.1	87	118	102	56	44	58
PBN46	1"	5.1	100	123	104	67	44	58
PCNB6	4"	5.1	262	243	180	202	44	58

NOTE : USE OF FILTER IN THE INLET PORT IS RECOMMENDED.

## Technical Data :

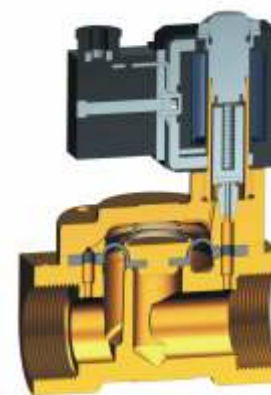

Section View

Model No.	Body Material	Pipe (inch)	Orifice (mm)	Min. Operating Pressure kg/cm <sup>2</sup>	Max. Operating Pressure kg/cm <sup>2</sup>	Seal & Diaphragm Material	Flow Factor Kv m <sup>3</sup> /hr
PBN260	Brass	1/2"	12.00	0.30	10	NBR / EPDM / VITON	2.10
PBN36	Brass	3/4"	20.00	0.30	10	NBR / EPDM / VITON	5.50
PBN46	Brass	1"	25.00	0.30	10	NBR / EPDM / VITON	9.00
PCNB6	CF8/CF8M	4"	98.00	0.30	10	NBR / EPDM / VITON	115.00

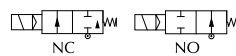
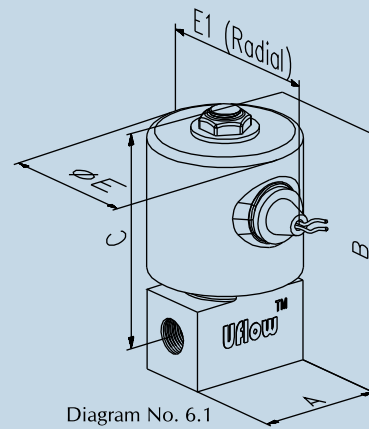

## Specifications :

Port :	Refer below technical data sheet(Available BSP / NPT)				
End Connection :	Screwed				
Body Material :	SS ASTM A351 Grade CF8 / CF8M, Aluminum, Forged Brass				
Seal & 'O' Ring :	Nitrile (NBR)	EPDM	Viton (FKM)	PTFE	
Media Temp :	-30° C to 90° C	-10° C to 140° C	-10° C to 180° C	-10° C to 180° C	
Circumstance Temp :	-10° C to 90° C				
Media :	Air, Water, Steam, Hot Water, Chemical, Gases, Oil				
Main Features :	Internal Parts are in superior corrosion resistance steel (Equivalent to SS316L) Suitable for Food Industries, Pharmaceuticals, Chemical applications & Highly corrosive environment.				
Operating Voltage :	24 AC	110 AC	230 AC	12 DC	24 DC
Power Consumption :	7W	8W	9W / 17W	10W	11W
Coil Features :	High Reliability Unaffected by Voltage Surges. Easy coil changes coil lockable in 4X90 position or freely movable in between as require.				
Coil Housing :	Epoxy square coil, metallic round enclosure, IP-67 Flame proof enclosure, IP-68 Weather proof enclosure.				
Optional Feature :	90% Power saver series also available.				
Other Specification Data :	Available on Request				

## Dimension : (NC)

Model No.	Port Size	Diagram No.	A	B	C	E	E1
DAN14	1/4"	6.1	43.50	84	73	44	58
DBN14	1/4"	6.1	43	83.50	74	44	58
DCN14	1/4"	6.1	44	83	74	44	58
DBN74	3/8"	6.1	48	88	74.75	44	58
DBN24	1/2"	6.1	48	88	74.75	44	58
DCN223	1/2"	6.1	61.50	109	96	50	63
DAN243	1/2"	6.1	65	102.4	88.5	50	63
DBN1C	1/4"	6.1	43	83.50	75	44	58
DBN2C	1/2"	6.1	48	88	74.75	44	58
DBN7C	3/8"	6.1	48	88	74.75	44	58

In Normally open valve Dimension will increase up to 8mm in B & C



Section View

NOTE : USE OF FILTER IN THE INLET PORT IS RECOMMENDED.

## Technical Data :

Model No.	Body Material	Pipe (inch)	Orifice(mm)		Min. Operating Pressure kg/cm <sup>2</sup>	Max. Operating Pressure kg/cm <sup>2</sup>	Seal & 'O' Ring Material	Flow Factor Kv m <sup>3</sup> /hr	
			NC	NO				NC	NO
DAN14	Aluminum	1/4"	3	2.5	0	10	NBR/ SI/ FKM/ EPDM	0.17	0.12
DBN14	Brass	1/4"	4	2.5	0	10	NBR/ SI/ FKM/ EPDM	0.3	0.12
DCN14	CF8/CF8M	1/4"	4	2.5	0	10	NBR/ SI/ FKM/ EPDM	0.3	0.12
DBN74	Brass	3/8"	4	2.5	0	10	NBR/ SI/ FKM/ EPDM	0.3	0.12
DBN24	Brass	1/2"	4	2.5	0	10	NBR/ SI/ FKM/ EPDM	0.3	0.12
DCN223	CF8/CF8M	1/2"	12	-	0	2	NBR/ SI/ FKM/ EPDM	1.8	-
DAN243	Aluminium	1/2"	5	3	0	10	NBR/ SI/ FKM/ EPDM	0.55	0.17
DBN1C	Brass	1/4"	1.3	0.9	0	150	NBR/ SI/ FKM/ EPDM	0.05	0.03
DBN2C	Brass	1/2"	1.3	0.9	0	150	NBR/ SI/ FKM/ EPDM	0.05	0.03
DBN7C	Brass	3/8"	1.3	0.9	0	150	NBR/ SI/ FKM/ EPDM	0.05	0.03

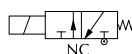
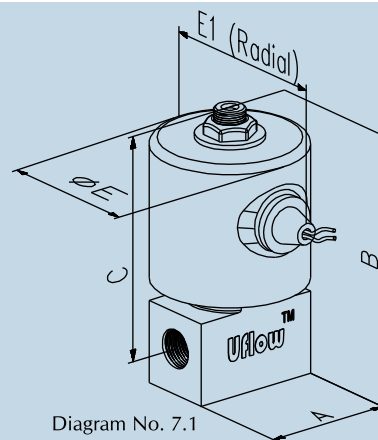

### Dimension :

All dimensions are in mm

Model No.	Port Size	Diagram No.	A	B	C	E	E1
TAN14	1/4"	7.1	43.50	90	78	44	58
TBN14	1/4"	7.1	43	90	80	44	58
TCN14	1/4"	7.1	44	89.50	80	44	58
TBN74	3/8"	7.1	48	93.5	80.5	44	58
TBN24	1/2"	7.1	48	93.5	80.5	44	58
TCN24	1/2"	7.1	48	93.5	80.5	44	58

### Specifications :

Port :	Refer below technical data sheet(Available BSP / NPT)				
End Connection :	Screwed				
Body Material :	SS ASTM A351 Grade CF8 / CF8M, Aluminum, Forged Brass				
Seal & 'O' Ring :	Nitrile (NBR)	EPDM	Viton (FKM)	PTFE	
Media Temp :	-30° C to 90° C	-10° C to 140° C	-10° C to 180° C	-10° C to 180° C	
Circumstance Temp :	-10° C to 90° C				
Media :	Air, Water, Chemical, Gases, Oil, Diesel, Kerosene, LPG.				
Main Features :	Internal Parts are in superior corrosion resistance steel (Equivalent to SS316L) Suitable for Food Industries, Pharmaceuticals, Chemical applications & Highly corrosive environment.				
Operating Voltage :	24 AC	110 AC	230 AC	12 DC	24 DC
Power Consumption :	7W	8W	9W / 17W	10W	11W
Coil Features :	High Reliability Unaffected by Voltage Surges. Easy coil changes coil lockable in 4X90 position or freely movable in between as require.				
Coil Housing :	Epoxy square coil, metallic round enclosure, IP-67 Flame proof enclosure, IP-68 Weather proof enclosure.				
Optional Feature :	90% Power saver series also available.				
Other Specification Data :	Available on Request				

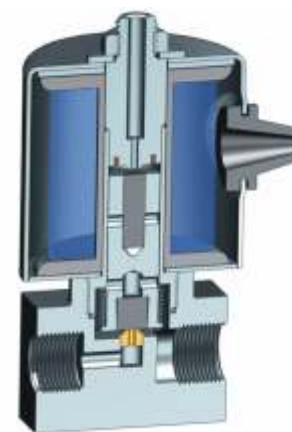

Section View

NOTE : USE OF FILTER IN THE INLET PORT IS RECOMMENDED.

### Technical Data :

Model No.	Body Material	Pipe (inch)	Orifice (mm)	Min. Operating Pressure kg/cm <sup>2</sup>	Max. Operating Pressure kg/cm <sup>2</sup>	Seal & 'O' Ring Material	Flow Factor Kv m <sup>3</sup> /hr
TAN14	Aluminum	1/4"	1.5	0	10	NBR/ SI/ FKM/ EPDM	0.07
TBN14	Brass	1/4"	1.5	0	10	NBR/ SI/ FKM/ EPDM	0.07
TCN14	CF8/CF8M	1/4"	1.5	0	10	NBR/ SI/ FKM/ EPDM	0.07
TBN74	Brass	3/8"	1.5	0	10	NBR/ SI/ FKM/ EPDM	0.07
TBN24	Brass	1/2"	1.5	0	10	NBR/ SI/ FKM/ EPDM	0.07
TCN24	CF8/CF8M	1/2"	1.5	0	10	NBR/ SI/ FKM/ EPDM	0.07



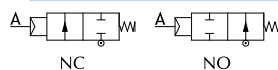
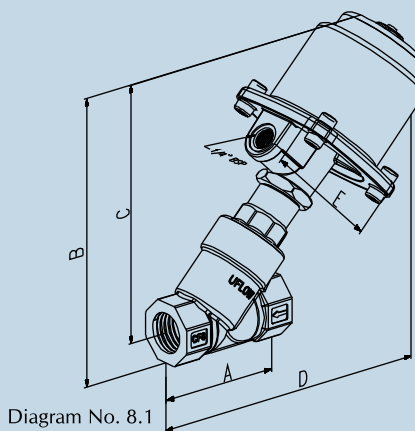

## Specifications :

Port :	Refer below technical data sheet(Available BSP / NPT)
End Connection :	Screwed / Flange
Body Material :	SS ASTM A351 Grade CF8 / CF8M
Seal :	Teflon, Viton /EPDM /Silicon
Circumstance Temp :	-10° C to 90° C
Media Temp :	-10° C to 180° C
Media :	Steam, Air, Water, Chemical, Gases, Oil, Diesel, Hot water
<b>ACTUATOR TYPE</b>	
Cover :	SS304
Plate :	Aluminum Die Cast
Working pressure :	3.5 to 7 bar air (Not recommended actuator pressure above 7 bar)
Life :	More Than Ten Million Cycle
Optional Feature :	Water Hammering reducer available to avoid water hammer forces
Other Technical Data :	Available on Request

## Dimension : (NC)

All dimensions are in mm

Model No.	Port Size	Diagram No.	A	B	C	D	E
YCP25	1/2"	8.1	64.5	170	154.50	177	90
YCP35	3/4"	8.1	74.5	180	160.50	180	90
YCP45	1"	8.1	89.5	186	164	189	90
YCP55	1 1/4"	8.1	124	210	180.50	217	90
YCP65	1 1/2"	8.1	124	210	180.50	217	90
YCP83	2"	8.1	150	227	191.50	232.50	90

NOTE : USE OF FILTER IN THE INLET PORT IS RECOMMENDED.

## Technical Data :

Model No.	Body Material	Pipe (inch)	Orifice (mm)	Min. Operating Pressure kg/cm <sup>2</sup>	Max. Operating Pressure kg/cm <sup>2</sup>	Seal & 'O' Ring Material	Flow Factor Kv m <sup>3</sup> /hr
YCP25	CF8/CF8M	1/2"	15	0	16	PTFE/ VITON/ EPDM	4.00
YCP35	CF8/CF8M	3/4"	16	0	16	PTFE/ VITON/ EPDM	7.50
YCP45	CF8/CF8M	1"	23	0	16	PTFE/ VITON/ EPDM	13.50
YCP55	CF8/CF8M	1 1/4"	34.5	0	16	PTFE/ VITON/ EPDM	23.00
YCP65	CF8/CF8M	1 1/2"	34.5	0	16	PTFE/ VITON/ EPDM	32.00
YCP83	CF8/CF8M	2"	45	0	7	PTFE/ VITON/ EPDM	55.00



Section View

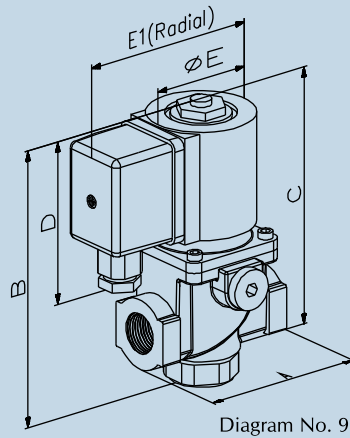

Diagram No. 9.1

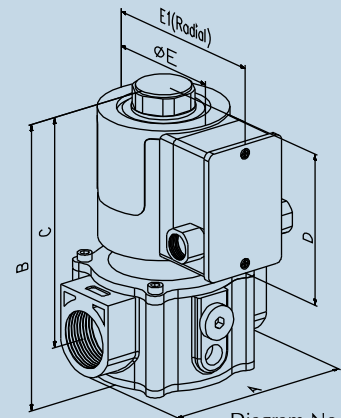
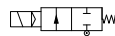

Diagram No. 9.2



Specifications :

Port :	Refer below Technical Datasheet (BSP)								
End Connection :	Screwed								
Body Material :	Aluminium Pressure die cast								
Diaphragm :	Nitrile (NBR)								
Circumstance Temp :	-10 °C to 60°C								
Media Temp :	-30 °C to 90 °C								
Media :	LPG, Natural Gas, Town Gas, Air.								
Main Features :	Flow adjustment, Opening time adjustment, Quick release initial flow adjustment.								
Operating Voltage :	<table border="1"> <tr> <td>110 AC</td> <td>230 AC</td> <td>12 DC</td> <td>24 DC</td> </tr> <tr> <td>33W</td> <td>33W</td> <td>33W</td> <td>33W</td> </tr> </table>	110 AC	230 AC	12 DC	24 DC	33W	33W	33W	33W
110 AC	230 AC	12 DC	24 DC						
33W	33W	33W	33W						
Power Consumption :									
Coil Features :	High Reliability Unaffected by Voltage Surges. Easy coil changes coil lockable in 4X90 position or freely movable in between as require.								
Coil Housing :	Epoxy Round coil								
Other Specification Data :	Available on Request								

Dimension :

All dimensions are in mm

Model No.	Port Size	Diagram No.	A	B	C	D	E	E1
DAN212	1/2"	9.1	72	136	107	72	50	78
DAN408	1"	9.2	109	165	133	85	71	105



DAN212



DAN408

Section View

NOTE : USE OF FILTER IN THE INLET PORT IS RECOMMENDED.

- Coils are Conforming as per IEC-60335-1 With Derivatives (LVD/EMC)
- Gas Solenoid Valves Complies as per EN-161 Requirement.

Technical Data :

Model No.	Body Material	Pipe (inch)	Orifice (mm)	Min. Operating Pressure mbar	Max. Operating Pressure mbar	Seal & 'O' Ring Material	Flow Factor Kv m <sup>3</sup> /hr
DAN212	Aluminum	1/2"	15	0	500	NBR	4.00
DAN408	Aluminum	1"	30	0	350	NBR	13.00

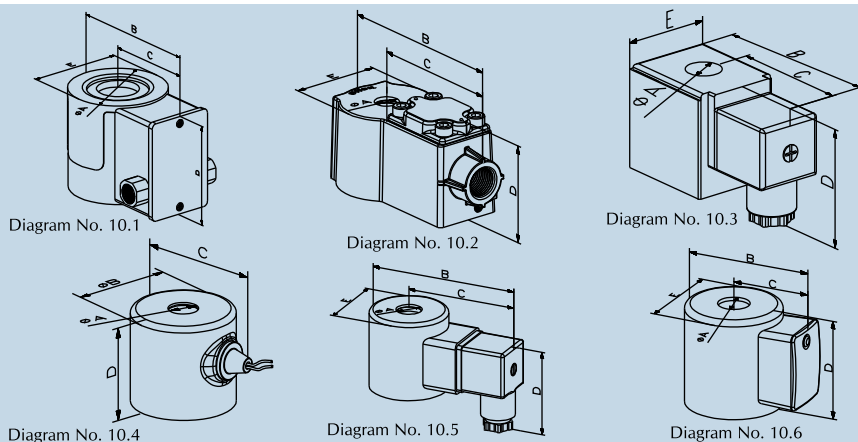

## Specifications :

Coil Type :	Epoxy Moulded With LED Din Connector, Metallic Round Shape With Lead Wire Continuous Duty, IP-67 Flame Proof Coil Enclosure, IP-68 Weather Proof Coil Enclosure				
Coil Bore Diameter :	10mm, 14mm, 16mm, 18mm, 30mm				
Class :	H-Class, Weather Proof IP-68, Flame Proof IP-67				
Voltage :	24 AC	110 AC	230 AC	12 DC	24 DC
Watt :	7W	8W/33W	9W/17W/33W	10W/33W	11W/33W
Duty :	100%				
Main Features :	Surge Suppressors for High Wattage Coil 90% Power saver series also available, Manual Override, Latching Coil.				
Latching Coil Benefits :	<ul style="list-style-type: none"> <li>● Remote or battery operated applications.</li> <li>● A situation where a valve needs to be open/actuated for an extended period of time</li> <li>● When heat rise occurring from the coil being constantly energized to maintain its position is an unacceptable side effect in your application.</li> </ul>				

End connections in Flame Proof Coils are available in  
 - 1/2" NPT  
 - 3/4" NPT  
 - M20 x 1.5

## Dimension :

All dimensions are in mm

Type	Diagram No.	A	B	C	D	E
Epoxy Moulded Round Coil	10.1	30.5	105	69	73	71
Flame Proof Coil Enclosure	10.2	14.5	112	86	61	52
Epoxy Moulded With LED Din Connector	10.3	14.5	75	54	51	37
Epoxy Moulded With LED Din Connector	10.3	10.3	64	51	46	26
Metallic Round Shape With Lead Wire	10.4	14.5	44	58	47.5	-
Metallic Round Shape With Lead Wire	10.4	10.3	28	-	30	-
Metallic Round Shape LED Din Connector	10.5	14.5	91	66.5	59	44
Metallic Round Shape Power Saver	10.6	14.5	58.5	36.6	47	44

**We Are Introducing New Power Saver Series(VA Series) Served by Our R&D Department, This New Latest Technology Saves Up to 90% of Power.**

**Benefits:**  
 Reduce Battery Drain, Reduce Wiring Cost, Reduce Temperature Rise, Energy Savings, Improve Valve Performance at High Pressure, Low Wattage

- Whether proof Coils are Conforming as per IEC/60529-2001 (Approved by ERDA) (IP-67)
- Flame Proof Coils conforming as per IS/IEC-60079-1:2007 (Approved by CIMFR)
- Coils are suitable for IIC Atmosphere Condition (Zone 1&2 Gas Group)
- Flame Proof Series are followed under BIS.
- For Flame Proof condition Working Environment Coils are licenced under PESO

## Coil Identification Chart

FAI09H				
COIL HOUSING	VOLTAGE	COIL BORE	WATTAGE	CONNECTION
R ROUND	A 230 V AC	G 10 mm	00 0.0	S SOCKET
M EPOXY	B 24 V AC	H 13 mm	01 1.0	L LEAD WIRE
W WEATHER PROOF	C 42 V AC	I 14 mm	02 2.0	H 1/2" NPT
F FLAME PROOF	D 48 V AC	J 16 mm	03 3.0	M M20 X 1.5
P POWER SAVER	E 110 V AC	K 18 mm	04 4.0	T 3/4" NPT
	F 12 V DC	L 20 mm	05 5.0	
	G 24 V DC	M 22 mm	06 6.0	
	H 230 V UAC	N 24 mm	07 7.0	
	J 230 V FAC	O 26 mm	08 8.0	
		P 28 mm	09 9.0	
		Q 30 mm	10 10.0	
			11 11.0	
			12 12.0	
			⋮ ⋮	
			33 33.0	

FAI09H  
 FLAME PROOF 230V AC (14mm) 9.0 W



Power Saver Series



Flame Proof Coil Enclosure

Section View



## Features :

**Uflow has successfully developed compact, patented aluminium free rack & pinion, Consuming less air Volume.**

- Wear proof Aluminium free rack & Pinion design
- Low air consumption with maximum torque due to compact designed
- Providing Hard anodized body for High Corrosion resistance
- Smooth travelling stroke for extending life of ball valve sheet
- Finer teeth module for smoother operation, and jerk free sliding
- Constant torque at any angle rotation
- Tested under 2 million cycle at maximum torque
- Maintenance Free Design

### Data :-

- Temperature range  
NBR = -20 C to +80 C  
Viton = -20 C to +125 C  
Flourosilicone -60 C to +110 C
- Maximum working pressure 8 bar

### End Stroke :- (0° 90°)

- +5° over travelling possible for opening
- -5° under travelling can be adjusted

## Torque Chart :

Model	2 bar	3 bar	4 bar	5 bar	6 bar	7 bar	8 bar
AD50	10.8	16	21.5	27	32.5	38	43

### Air consumption comparison with other Reputed brand

Model	Piston Inward Stroke, ml / bar	Piston Outward Stroke, ml / bar
(Uflow) AD50	144	80
Other Brand X	260	150
Other Brand Y	200	110

Double Acting Actuator 90 Degree

TORQUE Nm (10 Nm = 1 Kgm)

Aluminium Extruded, Hard Anodized Body

90 Degree Rotation, +5/-5 Degree

1Nm to 115 Nm

## Dimension :

Model	A	B	C	D	E	F	G	I	J	K	L	M	N	O	P	N1	O1	P1	ISO	FLANGE
AD50	119	76	21	72	65	30	80	13	4	16	12	1/4"	M6	12	50	M5	10	36	F03	F05

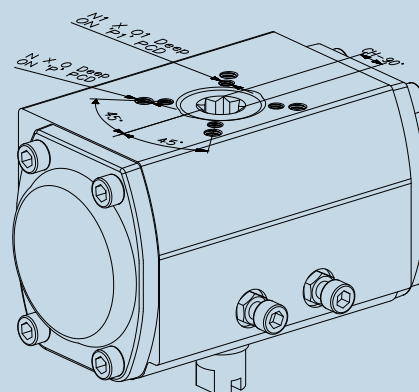
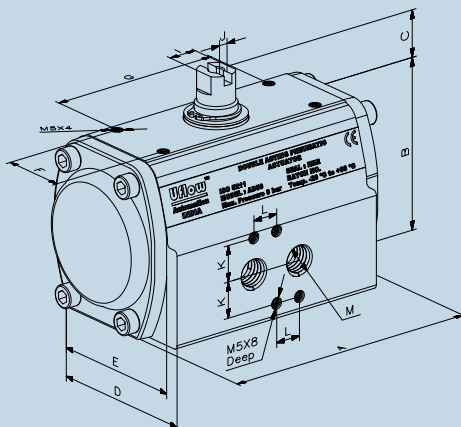

## Testing Facilities

### Routine Test :

- Body and Seat Leakage Test
- Pick up Drop Down Test
- Di-Electric Test
- Insulation Resistance Test

### Special Test we offer :

- Flow Test
- Hydro Test
- Seismic Test
- Burning Test
- Temperature Test
- Helium Test
- Accelerated Ageing Test
- LOCA Simulation Test
- Radiation Qualification Test

## Model Identification Chart

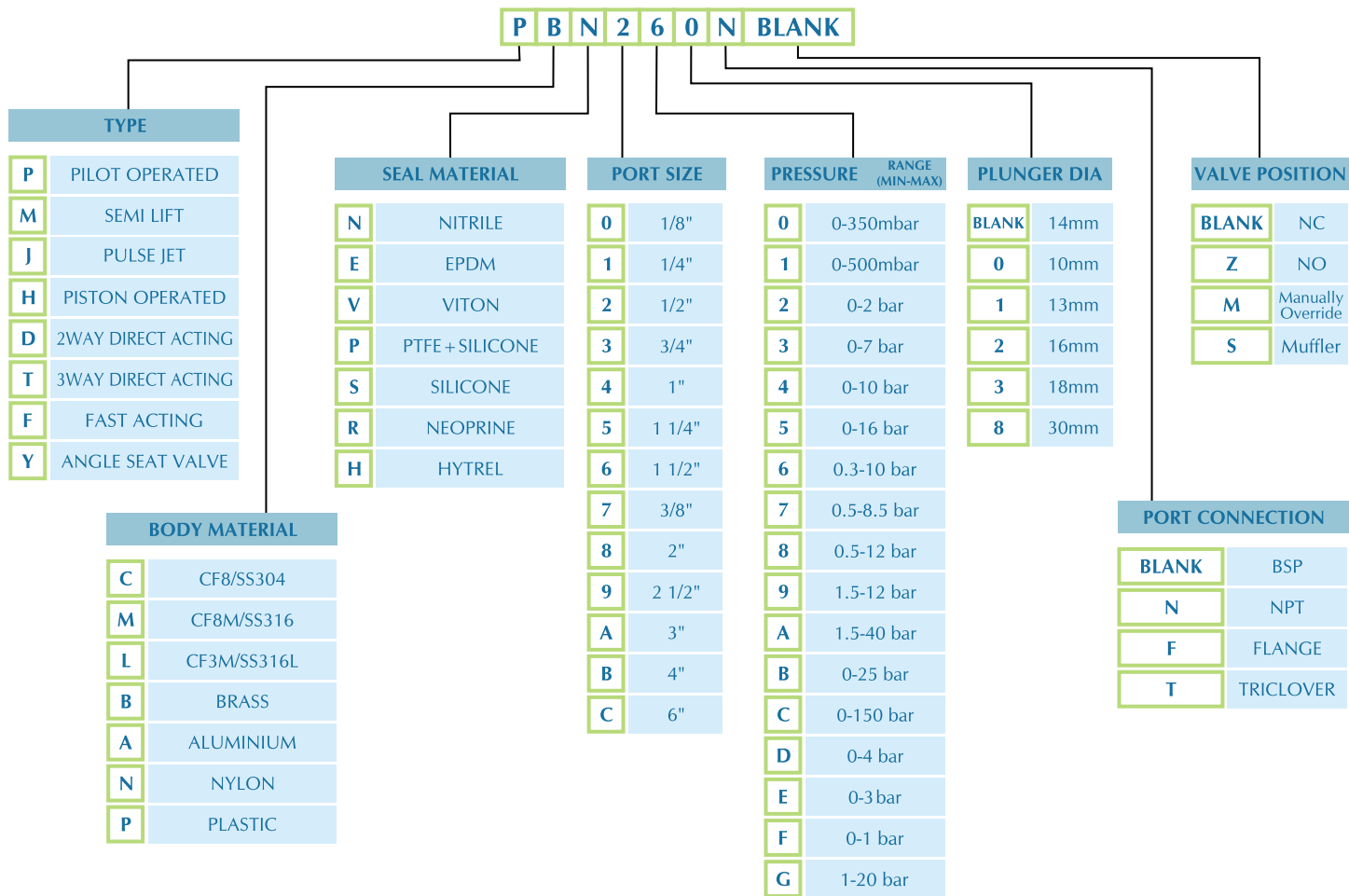

**MCN8D3**  
2" UMD Diaphragm Solenoid Valve (0-4Kg) (18mm)



Some Space for YOU...

Project management

Valves

Certification

Systems

Excellence

Flow

Experience

Sensors



## Our Clients



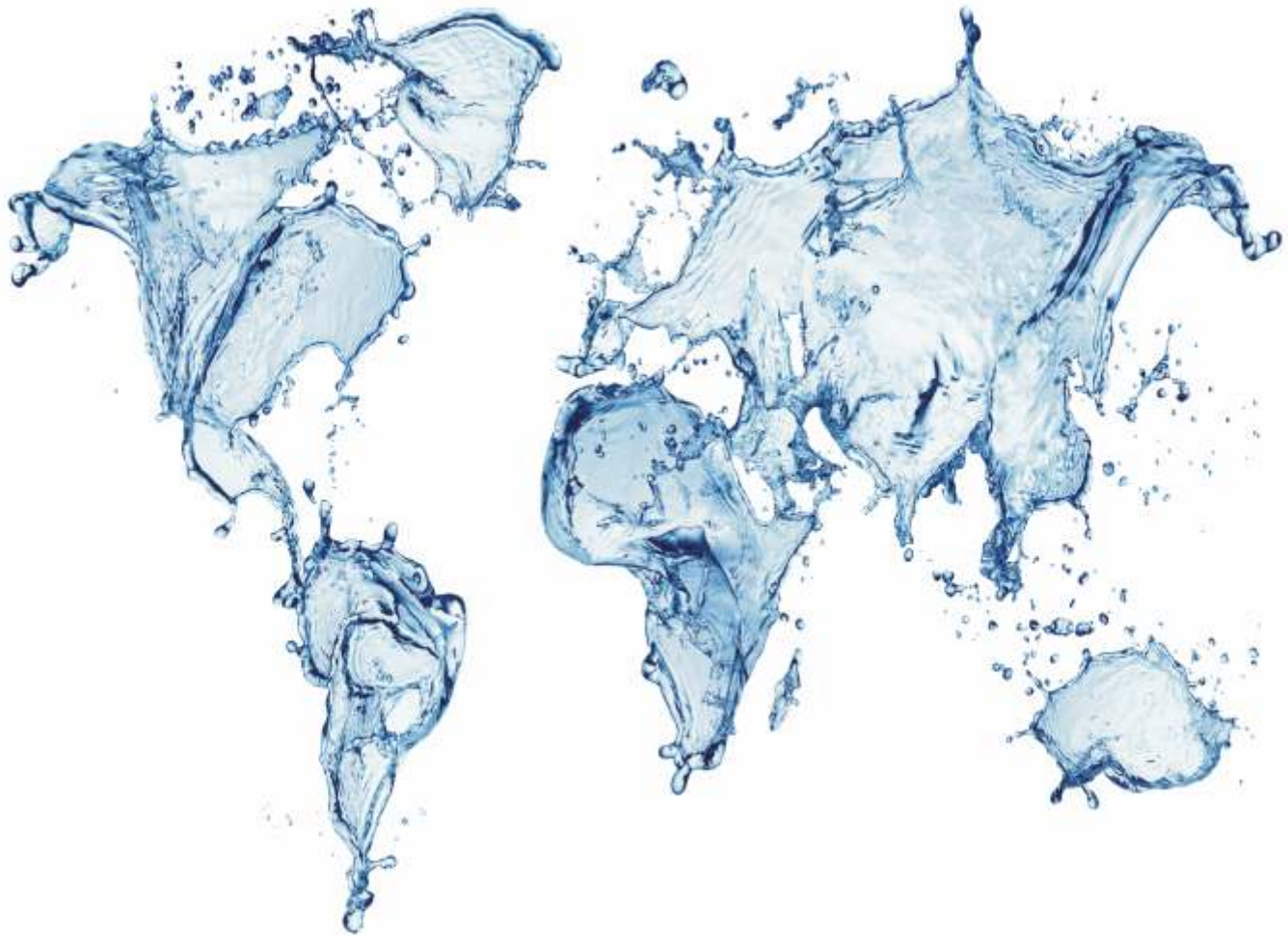

**L. N. Engineering**

Every Things in Eng. & Pneumatic Products

639/12, 1st floor, Chhotalal harilal's dehla, Opp. Marshal Hotel,  
Kapasia Bazar, Kalupur, Ahmedabad - 380001, Gujarat, India.

Phone: +91 79 2213 2626 / 2213 2625

Email: [info@lnengineering.in](mailto:info@lnengineering.in) / [lneng.lalit@yahoo.in](mailto:lneng.lalit@yahoo.in)

Website: [www.lnengineering.in](http://www.lnengineering.in)